

# BULOVA

## HOW TO CHANGE A STRAP



**BULOVA'S INTEGRATED INTERCHANGEABLE STRAPS ARE SUPER EASY TO REMOVE AND INSTALL. NO TOOLS REQUIRED.**

### WATCH PREPARATION



Place the watch on a soft cloth with the caseback facing up.

### REMOVING EXISTING BRACELET



To remove the existing bracelet, squeeze the quick-release pins together to release the spring bar from the lug holes and pull out the bracelet.



Repeat on the other side.

### INSTALLING NEW STRAP

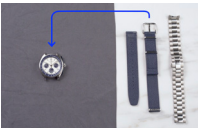

Before you install a new strap, note that the strap with a buckle goes on the 12 o'clock side.

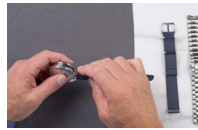

We're starting with the other strap here on the 6 o'clock side. Insert one end of the spring bar into the lug hole.



Push the quick-release pin to compress the spring bar, slide the strap and snap into place.



Now take the strap with the buckle and repeat on the 12 o'clock side.



Gently pull the strap to make sure both sides of the spring bar are completely inserted into the lug holes.



Finish by pulling the strap through the belt loop and now you're done!

### INSTALLING BRACELET



When installing the bracelet back on, note that the tuning fork is right side up and the top end goes on the 6 o'clock side.



Squeeze the quick-release pins together, align them with the lug holes and release. Make sure both sides of the bar are completely inserted by gently pulling the bracelet.



Repeat on the other side and you're done!